

Work Procedure

Description:	Platform Controls Forming Option Installation Instructions
Document No.:	AUS3379
Revision:	A
Date:	23 October 2012
Model:	GS and GR with Gen 5 Platform Controls
Author:	M. Randle

1.0 Introduction

This procedure is for the installation of the platform controls forming option on Genie GS slab scissor lifts and GR aerial work platforms fitted with Gen 5 platform controls using the following kits:

AUS3381 Kit Platform Controls Forming Gen 5 GS:

Use kit for GS-1532, GS-1932, GS-2032, GS-2632, GS-3232, GS-2046, GS-2646 and GS-3246 fitted with Gen 5 platform controls.

ITEM	PART NO.	DESCRIPTION	QTY
1	AUS3374	FORMING PLATFORM CONTROLS GEN 5 GS	1
2	6090	SCREW,HHC,1/4-20 X .75	1
3	6356	WASHER,LOCK,.25	1
4	AUS3376	RIVET ALUMINIUM SHELL, STEEL STEM 4.8MM X 11MM	3
5	65052	DECAL,LABEL,FAULT CODES	1
6	AUS3379	INSTALLATION INSTRUCTIONS FORMING PCON GEN 5	1

AUS3382 Kit Platform Controls Forming Gen 5 GR:

Use kit for GR-15 and GR-20 fitted with Gen 5 platform controls.

ITEM	PART NO.	DESCRIPTION	QTY
1	AUS3375	FORMING PLATFORM CONTROLS GEN 5 GR	1
2	6090	SCREW,HHC,1/4-20 X .75	1
3	6356	WASHER,LOCK,.25	1
4	AUS3376	RIVET ALUMINIUM SHELL, STEEL STEM 4.8MM X 11MM	3
5	65052	DECAL,LABEL,FAULT CODES	1
6	AUS3379	INSTALLATION INSTRUCTIONS FORMING PCON GEN 5	1

2.0 Required Tools

- 7/16 inch combination wrench
- Automatic centre punch
- Protective eye wear
- Hand drill, air or electric
- 3 mm or 1/8 inch drill bit
- 4.9 mm or #10 drill bit
- Deburring tool
- Rivet gun

3.0 Procedure

Note: Perform this procedure on a firm, level surface with the platform in the stowed position.

Install AUS3381 Kit Platform Controls Forming Gen 5 GS on GS-1532, GS-1932, GS-2032, GS-2632, GS-3232, GS-2046, GS-2646 and GS-3246 fitted with Gen 5 platform controls

1. Turn the key switch to the off position.
2. Disconnect the battery pack from the machine.

⚠WARNING Electrocution/burn hazard. Contact with electrically charged circuits could result in death or serious injury. Remove all rings, watches and other jewellery.

3. Working at the platform, tag and disconnect the control cable from the platform controls.
4. Remove the platform controls from the platform and place the controls on a workbench.
5. Working with the platform controls, using the provided 1/4-20 x 0.75 inch screw and washer, install the provided platform controls forming (part number AUS3374) onto the platform controls mount. Refer to Illustration 1.

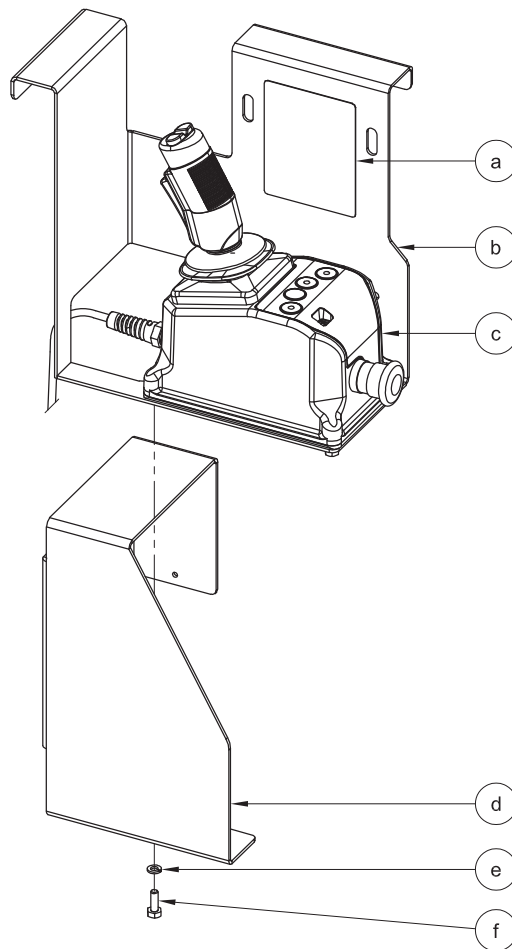

Illustration 1

- a decal, fault codes
- b platform controls mount
- c platform controls
- d platform controls forming
- e washer
- f screw

6. Using the mounting holes on the platform controls forming as a template and an automatic center punch, mark three hole locations on the front / side of the platform controls mount. Refer to Illustration 2.

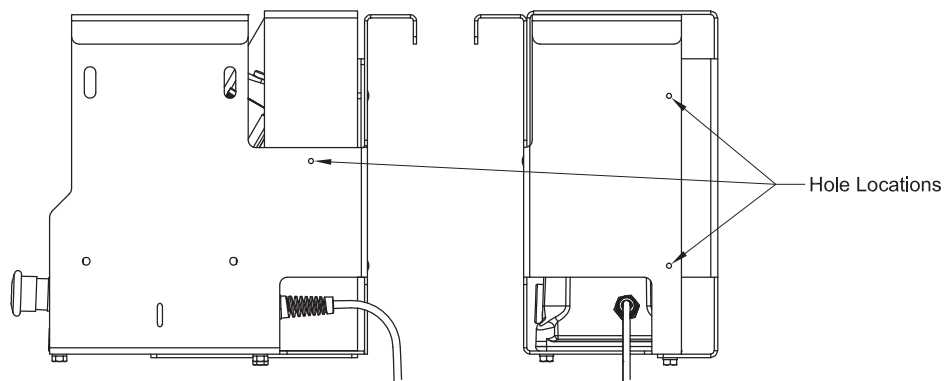

Illustration 2

7. Remove the 1/4-20 x 0.75 inch screws and washers securing the platform controls mount and platform controls forming to the platform controls. Set the platform controls, platform controls forming, screws and washers to the side. Refer to Illustration 3.
8. Remove and discard fault codes decal on front of platform controls mount. Refer Illustration 3.
9. Install the provided the fault codes decal (part number 65052) on side of platform controls mount. Refer Illustration 1.

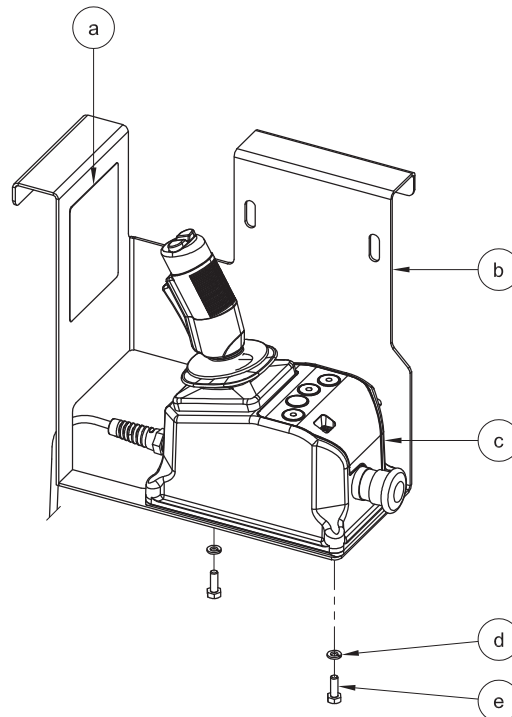

Illustration 3

- a decal, fault codes
- b platform controls mount
- c platform controls
- d washer
- e screw

10. Wearing protective eyewear and using a 3 mm or 1/8 inch drill bit, carefully drill three pilot holes in the locations marked in Step 6.
11. Wearing protective eyewear and using a 4.9 mm or #10 drill bit, enlarge the three pilot holes. Deburr the holes.

CAUTION Bodily injury hazard. Edges of the holes may be sharp. Use caution when deburring.

12. Using the fasteners removed in Step 7, install the platform controls forming and platform controls onto the platform controls mount. Torque the fasteners to 100 in-lbs / 11.3 Nm.
13. Using a rivet gun, install the provided 4.8 mm rivets in the three holes drilled in Step 11 to secure platform controls forming to platform controls mount. Refer to Illustration 4.

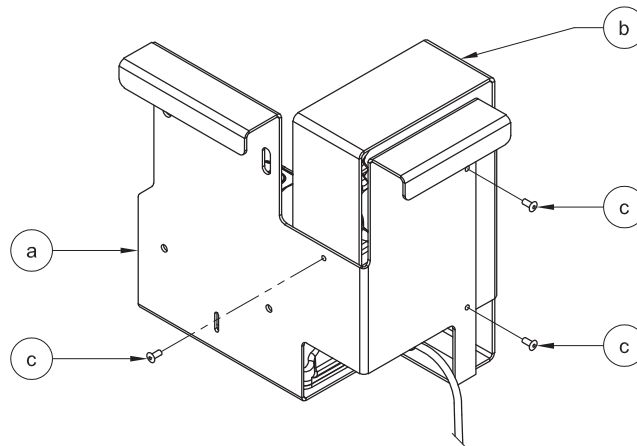

Illustration 4

- a platform controls mount
- b platform controls forming
- c rivet

14. Install the platform controls onto the platform.
15. Securely connect the control cable to the platform controls.
16. Connect the battery pack to the machine.

Finish the Installation

17. Perform function tests. Refer to the Operator's Manual on your machine.
18. Return the machine to service.

Install AUS3382 Kit Platform Controls Forming Gen 5 GR on GR-15 and GR-20 fitted with Gen 5 platform controls

Note: Campaign Bulletin 090012 Platform Controller Guard must be completed on the machine before proceeding with this procedure.

1. Turn the key switch to the off position.
2. Disconnect the battery pack from the machine.

⚠WARNING Electrocution/burn hazard. Contact with electrically charged circuits could result in death or serious injury. Remove all rings, watches and other jewellery.

3. Working at the platform, tag and disconnect the control cable from the platform controls.
4. Unlatch and remove the platform controls from the platform and place the controls on a workbench.
5. Working with the platform controls, check that overall height of platform controls mount is 309 mm. Refer to Illustration 5. If overall height is not 309 mm, order and install latest revision of platform controls mount (part number 124428) from Genie Parts before proceeding with this procedure.

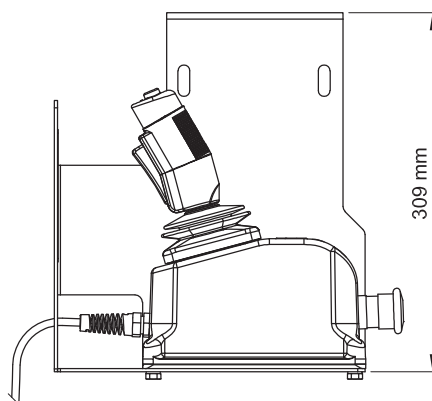

Illustration 5

6. Using the provided 1/4-20 x 0.75 inch screw and washer, install the provided platform controls forming (part number AUS3375) onto the platform controls mount. Refer to Illustration 6.

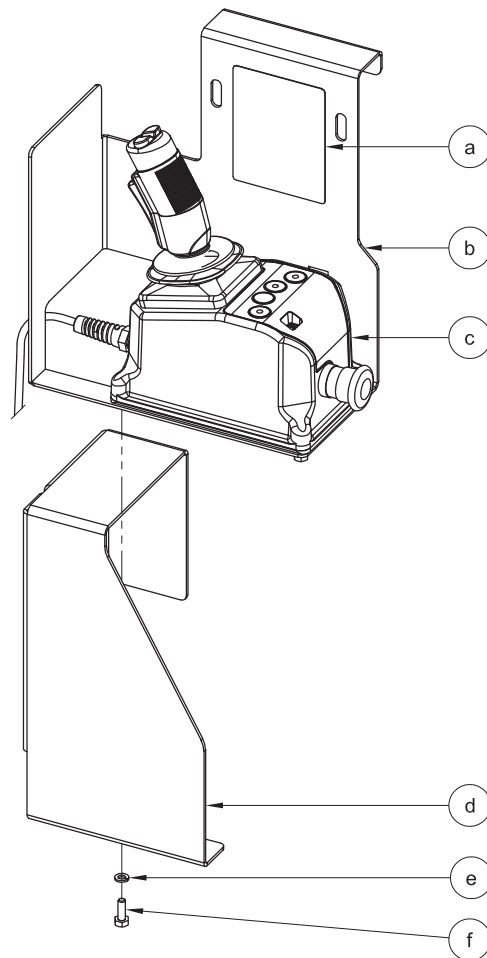

Illustration 6

- a decal, fault codes
- b platform controls mount
- c platform controls
- d platform controls forming
- e washer
- f screw

7. Using the mounting holes on the platform controls forming as a template and an automatic center punch, mark three hole locations on the front of the platform controls mount. Refer to Illustration 7.

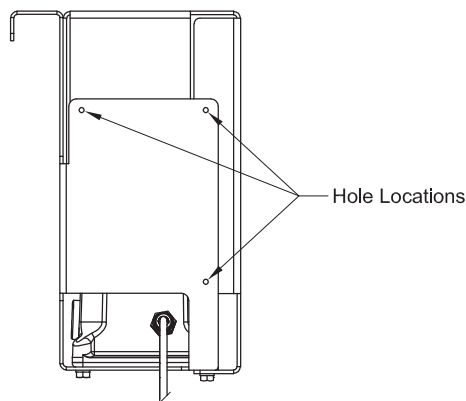

Illustration 7

8. Remove the 1/4-20 x 0.75 inch screws and washers securing the platform controls mount and platform controls forming to the platform controls. Set the platform controls, platform controls forming, screws and washers to the side. Refer to Illustration 8.
9. Remove and discard fault codes decal on front of platform controls mount. Refer Illustration 8.
10. Install the provided the fault codes decal (part number 65052) on side of platform controls mount. Refer Illustration 6.

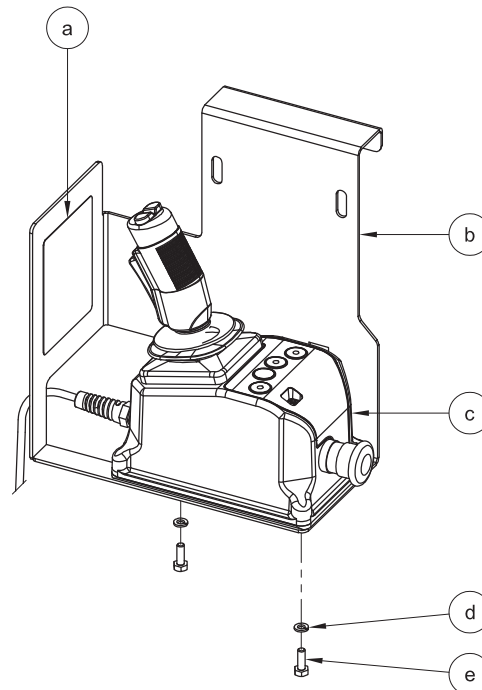

Illustration 8

- a decal, fault codes
- b platform controls mount
- c platform controls
- d washer
- e screw

11. Wearing protective eyewear and using a 3 mm or 1/8 inch drill bit, carefully drill three pilot holes in the locations marked in Step 7.
12. Wearing protective eyewear and using a 4.9 mm or #10 drill bit, enlarge the three pilot holes. Deburr the holes.

CAUTION Bodily injury hazard. Edges of the holes may be sharp. Use caution when deburring.

13. Using the fasteners removed in Step 8, install the platform controls forming and platform controls onto the platform controls mount. Torque the fasteners to 100 in-lbs / 11.3 Nm.
14. Using a rivet gun, install the provided 4.8 mm rivets in the three holes drilled in Step 12 to secure platform controls forming to platform controls mount. Refer to Illustration 9.

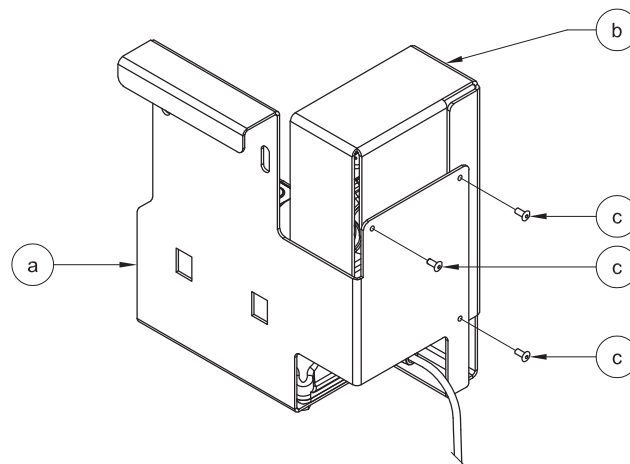

Illustration 9

- a platform controls mount
- b platform controls forming
- c rivet

15. Install the platform controls onto the platform and securely latch in place.
16. Securely connect the control cable to the platform controls.
17. Connect the battery pack to the machine.

Finish the Installation

18. Perform function tests. Refer to the Operator's Manual on your machine.
19. Return the machine to service.

4.0 Revision History

23/10/12 ECN 12049AU: Original issue.