

Work Procedure

| | |
|----------------------|--|
| Description: | Platform Controls Forming Option Installation Instructions |
| Document No.: | AUS3380 |
| Revision: | A |
| Date: | 24 October 2012 |
| Model: | GS and GR with Smartlink Platform Controls |
| Author: | M. Randle |

1.0 Introduction

This procedure is for the installation of the platform controls forming option on Genie GS slab scissor lifts and GR aerial work platforms fitted with Smartlink platform controls using the following kits:

AUS3383 Kit Platform Controls Forming Smartlink GS:

Use kit for GS-1532, GS-1932, GS-2032, GS-2632, GS-3232, GS-2046, GS-2646 and GS-3246 fitted with Smartlink platform controls.

| ITEM | PART NO. | DESCRIPTION | QTY |
|------|----------|--|-----|
| 1 | AUS3377 | FORMING PLATFORM CONTROLS SMARTLINK GS | 1 |
| 2 | AUS3376 | RIVET ALUMINIUM SHELL, STEEL STEM 4.8MM X 11MM | 3 |
| 3 | 133596 | DECAL,LABEL,FAULT CODES | 1 |
| 4 | AUS3380 | INSTALLATION INSTRUCTIONS FORMING PCON SMARTLINK | 1 |

AUS3384 Kit Platform Controls Forming Smartlink GR:

Use kit for GR-15 and GR-20 fitted with Smartlink platform controls.

| ITEM | PART NO. | DESCRIPTION | QTY |
|------|----------|--|-----|
| 1 | AUS3378 | FORMING PLATFORM CONTROLS SMARTLINK GR | 1 |
| 2 | AUS3376 | RIVET ALUMINIUM SHELL, STEEL STEM 4.8MM X 11MM | 3 |
| 3 | AUS3380 | INSTALLATION INSTRUCTIONS FORMING PCON SMARTLINK | 1 |

2.0 Required Tools

- 7/16 inch combination wrench
- Automatic centre punch
- Protective eye wear
- Hand drill, air or electric
- 3 mm or 1/8 inch drill bit
- 4.9 mm or #10 drill bit
- Deburring tool
- Rivet gun

3.0 Procedure

Note: Perform this procedure on a firm, level surface with the platform in the stowed position.

Install AUS3383 Kit Platform Controls Forming Smartlink GS on GS-1532, GS-1932, GS-2032, GS-2632, GS-3232, GS-2046, GS-2646 and GS-3246 fitted with Smartlink platform controls

1. Turn the key switch to the off position.
2. Disconnect the battery pack from the machine.

⚠WARNING Electrocution/burn hazard. Contact with electrically charged circuits could result in death or serious injury. Remove all rings, watches and other jewellery.

3. Working at the platform, tag and disconnect the control cable from the platform controls.
4. Remove the platform controls from the platform and place the controls on a workbench.
5. Working with the platform controls, using the existing 1/4-20 x 0.75 inch screw and washer, install the provided platform controls forming (part number AUS3377) onto the platform controls mount. Refer to Illustration 1.

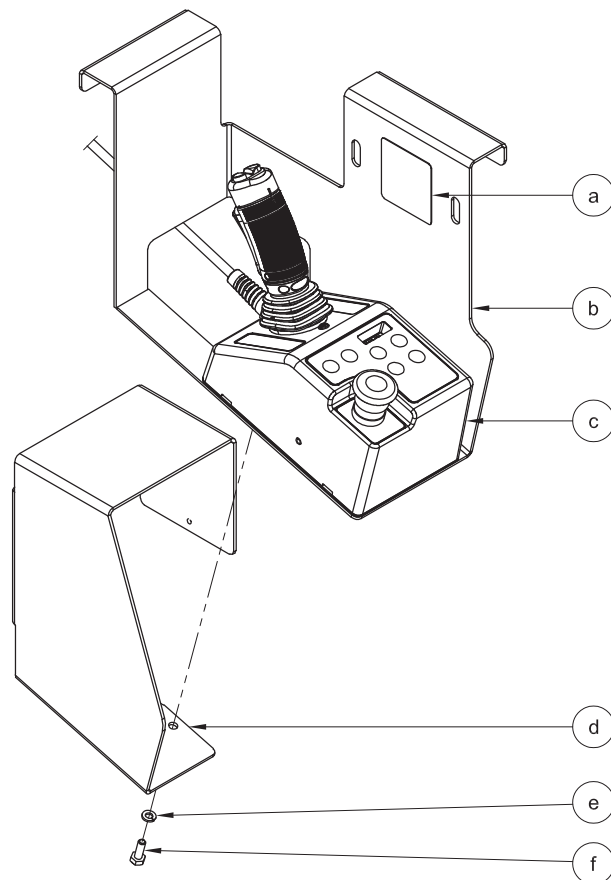

Illustration 1

- a decal, fault codes
- b platform controls mount
- c platform controls
- d platform controls forming
- e washer
- f screw

6. Using the mounting holes on the platform controls forming as a template and an automatic center punch, mark three hole locations on the front / side of the platform controls mount. Refer to Illustration 2.

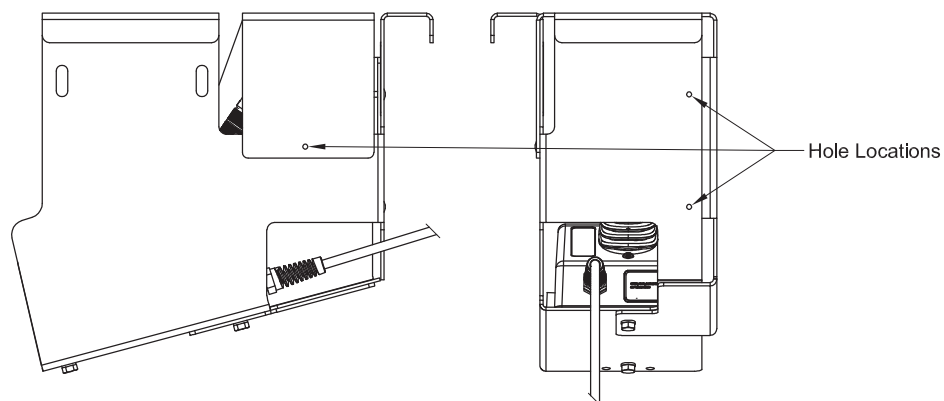

Illustration 2

7. Remove the 1/4-20 x 0.75 inch screws and washers securing the platform controls mount and platform controls forming to the platform controls. Set the platform controls, platform controls forming, screws and washers to the side. Refer to Illustration 3.
8. Remove and discard fault codes decal on front of platform controls mount. Refer Illustration 3.
9. Install the provided the fault codes decal (part number 133596) on side of platform controls mount. Refer Illustration 1.

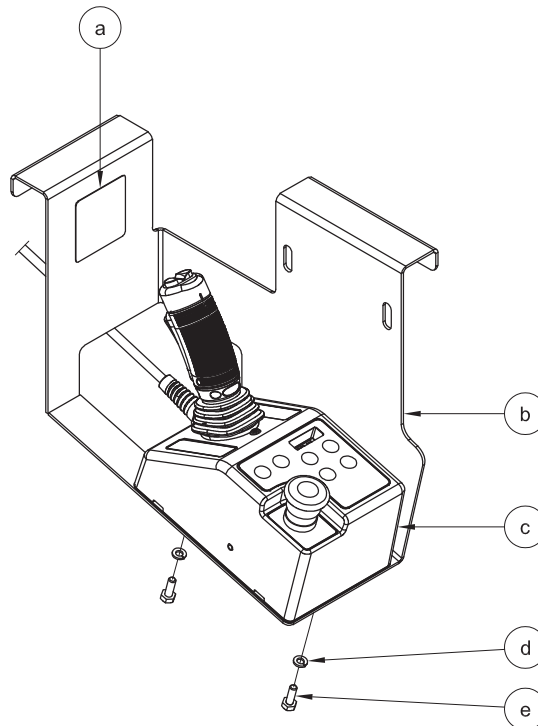

Illustration 3

- a decal, fault codes
- b platform controls mount
- c platform controls
- d washer
- e screw

10. Wearing protective eyewear and using a 3 mm or 1/8 inch drill bit, carefully drill three pilot holes in the locations marked in Step 6.
11. Wearing protective eyewear and using a 4.9 mm or #10 drill bit, enlarge the three pilot holes. Deburr the holes.

CAUTION Bodily injury hazard. Edges of the holes may be sharp. Use caution when deburring.

12. Using the fasteners removed in Step 7, install the platform controls forming and platform controls onto the platform controls mount. Torque the fasteners to 100 in-lbs / 11.3 Nm.
13. Using a rivet gun, install the provided 4.8 mm rivets in the three holes drilled in Step 11 to secure platform controls forming to platform controls mount. Refer to Illustration 4.

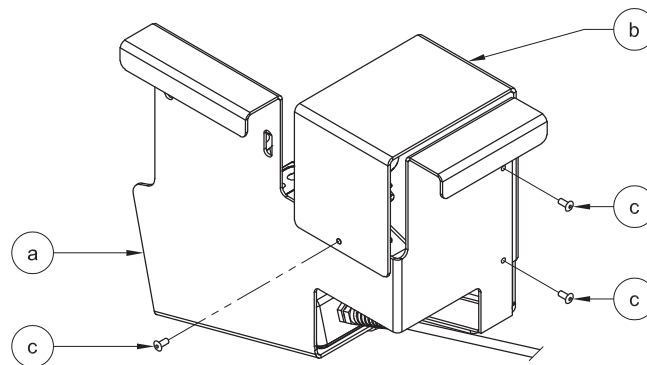

Illustration 4

- a platform controls mount
- b platform controls forming
- c rivet

14. Install the platform controls onto the platform.
15. Securely connect the control cable to the platform controls.
16. Connect the battery pack to the machine.

Finish the Installation

17. Perform function tests. Refer to the Operator's Manual on your machine.
18. Return the machine to service.

Install AUS3384 Kit Platform Controls Forming Smartlink GR on GR-15 and GR-20 fitted with Smartlink platform controls

1. Turn the key switch to the off position.
2. Disconnect the battery pack from the machine.

⚠ WARNING Electrocution/burn hazard. Contact with electrically charged circuits could result in death or serious injury. Remove all rings, watches and other jewellery.

3. Working at the platform, tag and disconnect the control cable from the platform controls.
4. Unlatch and remove the platform controls from the platform and place the controls on a workbench.
5. Working with the platform controls, using the existing 1/4-20 x 0.75 inch screw and washer, install the provided platform controls forming (part number AUS3378) onto the platform controls mount. Refer to Illustration 5.

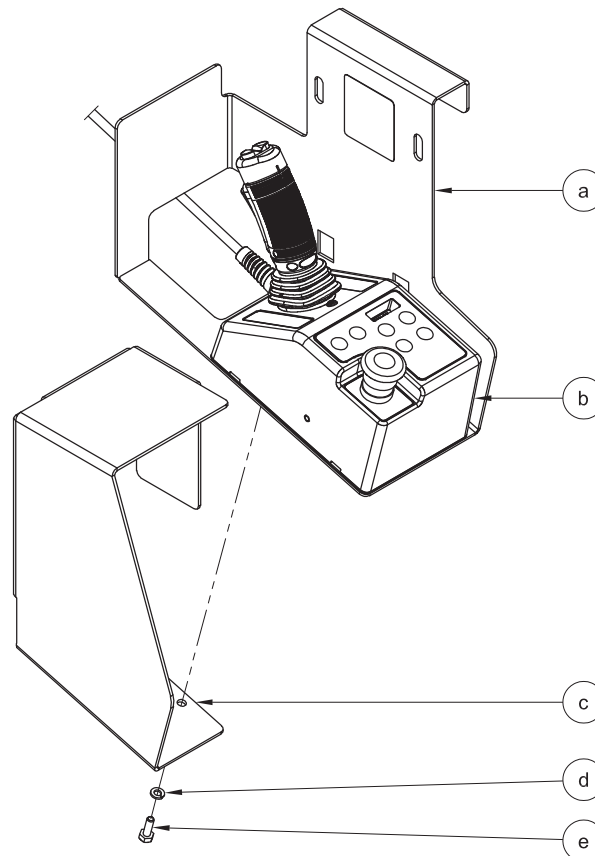

Illustration 5

- a platform controls mount
- b platform controls
- c platform controls forming
- d washer
- e screw

- Using the mounting holes on the platform controls forming as a template and an automatic center punch, mark three hole locations on the front of the platform controls mount. Refer to Illustration 6.

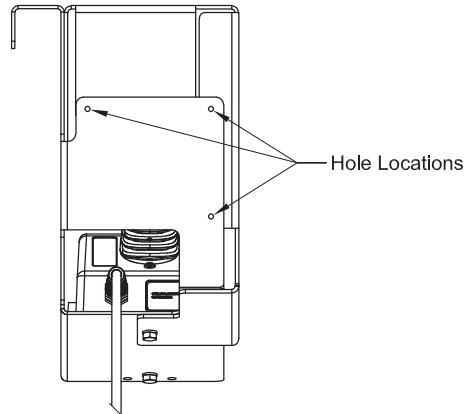

Illustration 6

- Remove the 1/4-20 x 0.75 inch screws and washers securing the platform controls mount and platform controls forming to the platform controls. Set the platform controls, platform controls forming, screws and washers to the side. Refer to Illustration 7.

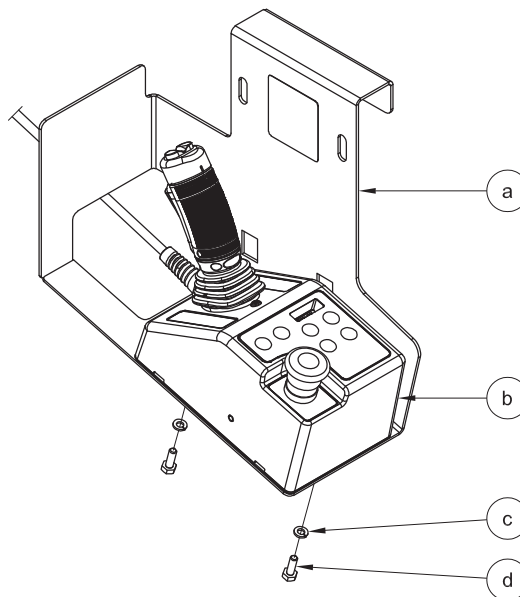

Illustration 7

- a platform controls mount
- b platform controls
- c washer
- d screw

8. Wearing protective eyewear and using a 3 mm or 1/8 inch drill bit, carefully drill three pilot holes in the locations marked in Step 6.
9. Wearing protective eyewear and using a 4.9 mm or #10 drill bit, enlarge the three pilot holes. Deburr the holes.

CAUTION Bodily injury hazard. Edges of the holes may be sharp. Use caution when deburring.

10. Using the fasteners removed in Step 7, install the platform controls forming and platform controls onto the platform controls mount. Torque the fasteners to 100 in-lbs / 11.3 Nm.
11. Using a rivet gun, install the provided 4.8 mm rivets in the three holes drilled in Step 9 to secure platform controls forming to platform controls mount. Refer to Illustration 8.

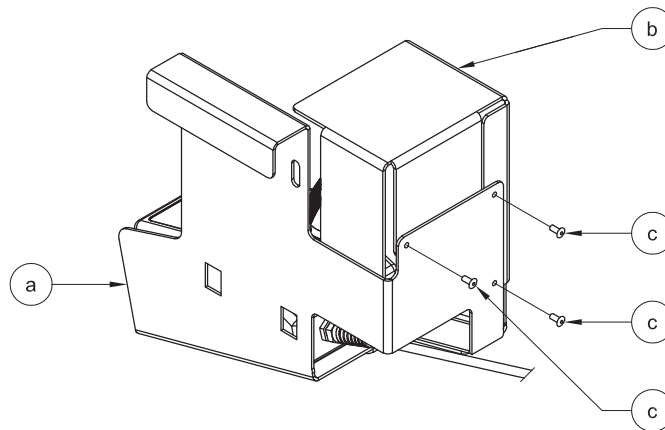

Illustration 8

- a platform controls mount
- b platform controls forming
- c rivet

12. Install the platform controls onto the platform and securely latch in place.
13. Securely connect the control cable to the platform controls.
14. Connect the battery pack to the machine.

Finish the Installation

15. Perform function tests. Refer to the Operator's Manual on your machine.
16. Return the machine to service.

4.0 Revision History

24/10/12 ECN 12049AU: Original issue.